

How to Add Symptom Checker to Home Page

Android:

- 1) **Launch Chrome** for Android and navigate to the web page <https://stevenson.mediatconnect.com>.
- 2) Tap the **Menu button** in Chrome on the right hand side



- 3) Choose **Add to Home Screen** on the drop down menu that appears. A dialog box will appear with the name of the site type in the box. Tap **Add** two times as shown below:

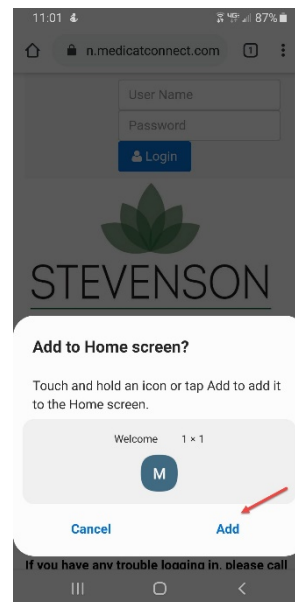
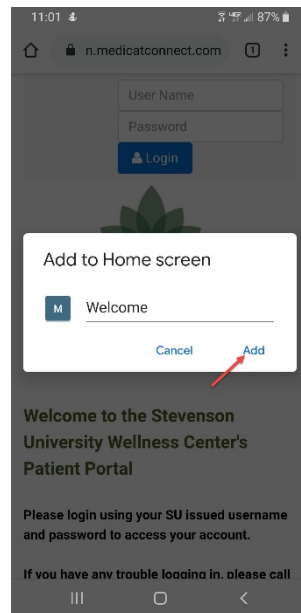
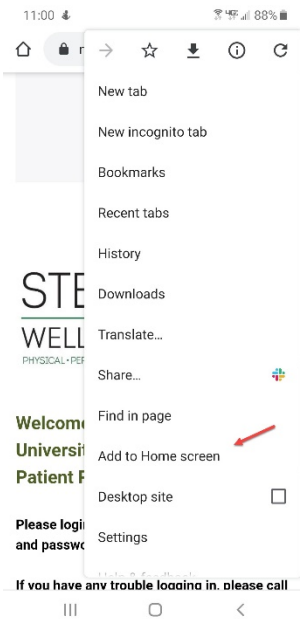

4) The icon for the symptom checker will appear as shown below:

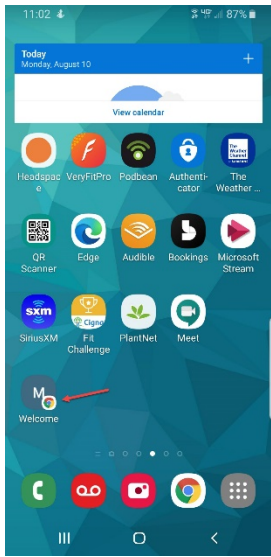

Apple:

- 1) **Launch Safari** for Apple's iOS and navigate to the web page <https://stevenson.medicatconnect.com> .
- 2) Tap the **Share button** on the browser's toolbar — that's the rectangle with an arrow pointing upward. It's on the bar at the top of the screen on an iPad, and on the bar at the bottom of the screen on an iPhone or iPod Touch.

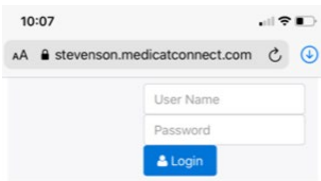

Welcome to the Stevenson University Wellness Center's Patient Portal

Please login using your SU issued username and password to access your account.

If you have any trouble logging in, please call the Wellness Center at 443-352-4200.

We highly recommend using Google Chrome or

Mozilla Firefox because of its compatibility issues.

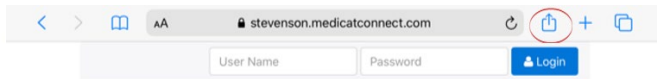

STEVENSON



3) Tap the **Add to Home Screen** icon in the Share menu. A dialog box will appear with the name of the site type in the box. Tap **Add** as shown below:

Menu that pops up (You may need to scroll down), and Confirmation after “Add to Home Screen.”

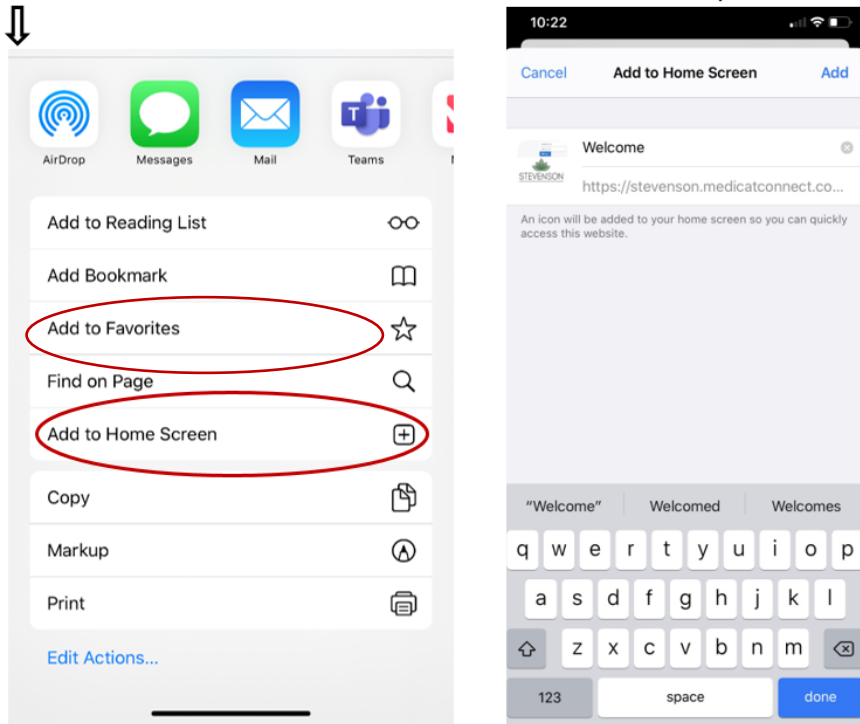

4) The icon for the symptom checker will appear as shown below:

